

AVAILABLE FOR HIRE

Use

The KI-B is a fork mounted lifting accessory which is used for the lifting and installation of wall panels. It is designed to lift sandwich panels for cladding and coldstore construction.



Benefits

- Reduces heavy lifting for site personnel
- Minimises damage to expensive composite sandwich panels
- Improves productivity by speeding up installation times
- Saves money by completing build programs quicker, thus reducing costs for plant hire and wages
- Dual circuit machine to EN13155:2003 requirements
- For lifting panels into vertical orientation (portrait) wall positions
- Fork mountable—For fork truck or telehandler
- Lower plant costs as no crane required



Technical

Application	- Vertical wall panels - 16m max length
Mounting	- Forklift or telehandler with minimum bearing capacity of 1500 KG
Panel width	- From 600mm to 1200mm wide
Panel thickness	- From 60 to 250mm
Panel core	- Pu, Pir or Rockwool core type panels can be lifted
Panel profiles	- Flat, Euro rib, micro rib, trapezoidal and most profiles available
Pad types	- Round and oval to fit most panel types
Pad seal	- Sealing rings available for most profiles—The right seal helps get quicker suction
Operating time	- 8-10 hours between re-charge depending on panel type and pad seal condition
Power	- 2 x 12 V 72 amp re-chargeable batteries on-board
Pumps	- 24v DC Oil free pump
Capacity	- 400 KG SWL Maximum
Weight	- 400 KG
Pads	- 250mm round or 100mm ovals (8 or 12 pads fitted to frame dependant on load)
Control	- Electronic control panel on cable drum
Charging unit	- 110 volt charging unit
Safety devices	- Audible and visual low vacuum warning devices

PHONE 01299 824 333 FAX 01299 382 200

WEB. www.vacuumandcrane.co.uk E-MAIL. info@vacuumandcrane.co.uk

Lifting Capability

Please refer to the table below for the safe working load for the KI-B depending on configuration

Pad Shape and quantity	SWL
Fitted with 8 round pads (250mm diameter)	250 KG
Fitted with 12 round pads (250mm diameter)	400 KG
Fitted with 8 oval pads (100mm x 320mm)	130 KG
Fitted with 12 oval pads (100mm x 320mm)	200 KG

Dimensions of KI-B

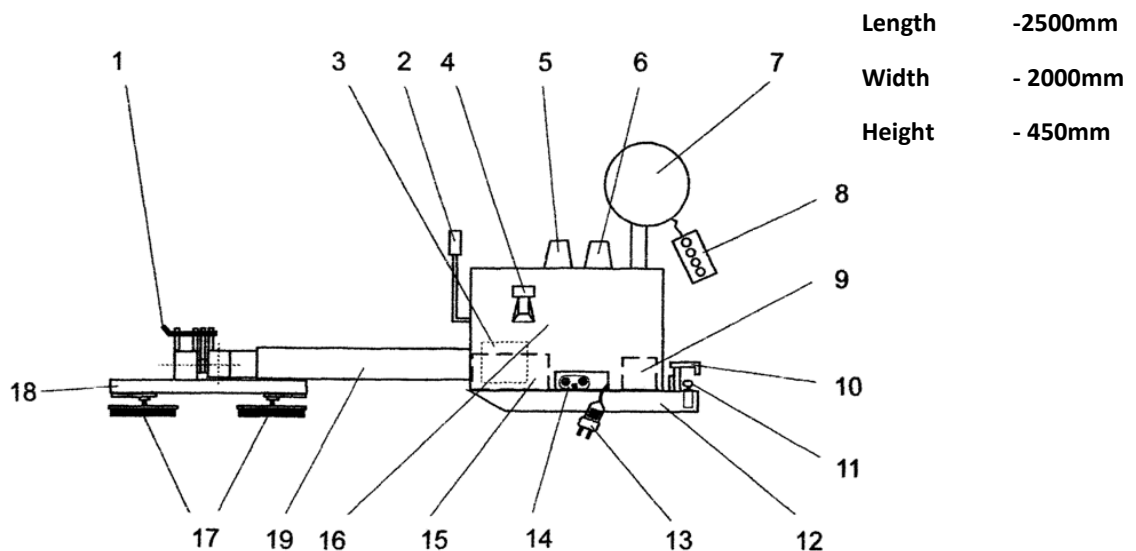

Fig. 1: Design of the OKTOPUS® KI-B

- | | |
|---|---|
| 1 Central locking lever | 11 Locking plates and screws, on both sides |
| 2 Vacuum gauge (2 pieces) | 12 Base frame with forked fittings |
| 3 Charge indicator (on top of the fuse box) | 13 Control circuit connector |
| 4 Acoustic alarm (under the cover) | 14 Battery socket |
| 5 Green Signal light | 15 Vacuum pump (under cover) |
| 6 Red Warning light | 16 Cover |
| 7 Cable drum for remote control | 17 Suction cups |
| 8 Control panel | 18 Suction bridge |
| 9 Water separator | 19 Arm |
| 10 Locking bracket for fork lift truck, central, with integrated locking bolt | |

PHONE 01299 824 333 FAX 01299 382 200

WEB. www.vacuumandcrane.co.uk E-MAIL. info@vacuumandcrane.co.uk